

Features and Benefits

Just Like Our Standard Big Block

- 16 SQFT per Block
- Metal Cross Tie System
- Any Core Width: 5-5/8" to 24"
- 3 Panel Heights, 12", 18", 24"
- Withstands 1600 lbs/SQFT

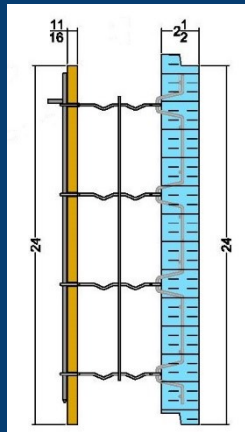

- Works perfect with R-Stak enhanced insulation walls
- Seamless integration with XpressWall program



PolycreteUSA

Richmond, VA
Bridgewater, NJ

800-570-4313

Info@PolycreteUSA.com

V1 IS THE FAST AND EFFECTIVE SOLUTION FOR ANY CAST IN PLACE CONCRETE WALL THAT REQUIRES INSULATION ON ONE SIDE AND FINISHED CONCRETE ON THE OTHER

Elevator shafts, stairwells, basements, garages, retail stores and entire warehouses. You're limited only by your imagination.

One side Regular EPS insulation/Other side re-usable Richply ULTRAFORM® panel

Conforms to Split Blok specification: mix and match panel height

V1's Polycrete EPS panel is 2.5" of steel-reinforced Type II expanded polystyrene insulation with horizontal galvanized steel fastening strips

Assembled with steel wire cross ties, EPS panel is ready to accept the strippable Richply wood form

Richply ULTRAFORM is factory coated with Nox-Crete release agent

Pre-drilled with 48 oblong holes to accept the cross ties

Galvanized steel rod locks down the ULTRAFORM panel in seconds.

Strip the ULTRAFORM panel just like any other traditional wood form

Unlike other blow-out prone one-sided ICFs, Polycrete's positive rod and loop system locks down the wood panel in the blink of an eye and withstands over 1,600 lbs / sqft of lateral pressure during the pour.

Each Richply ULTRAFORM Panel is Factory Drilled to Receive 12 Cross Tie Assemblies

Cross Tie Assemblies Are Spaced 8.375" Apart

Panels are Pre-Treated with Nox-Crete Release Agent

Each 24" Steel Rod Locks in One 4 Point Cross Tie Assembly

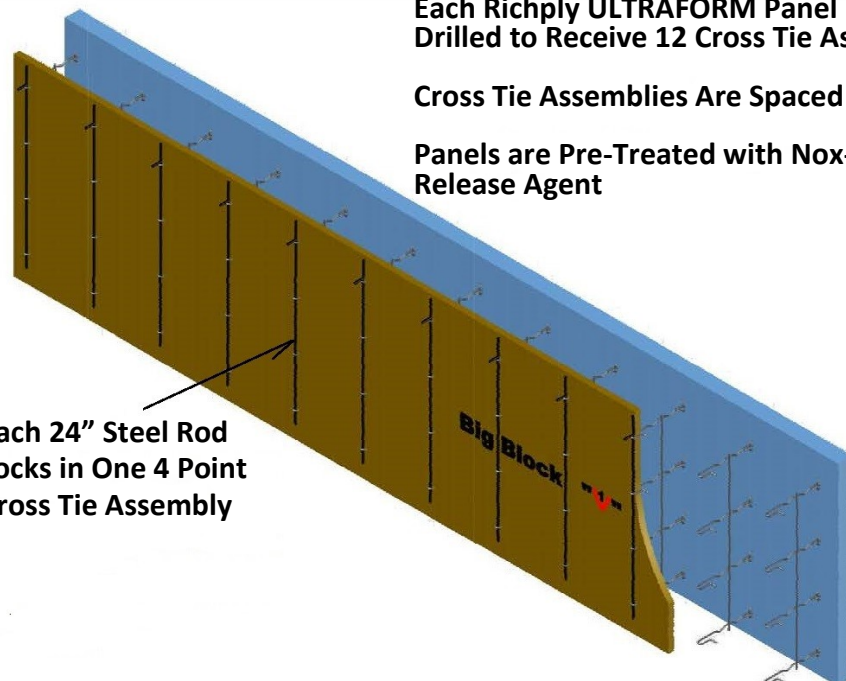

48 notches 1/4" X 5/8" pre-cut into the Richply ULTRAFORM panel

Steel rod positively in 4 part metal Cross Tie assembly

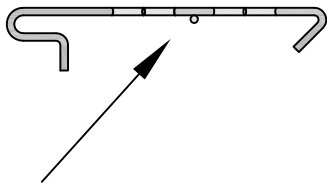

Top view of Cross Tie assembly

Plywood strip 1/2"

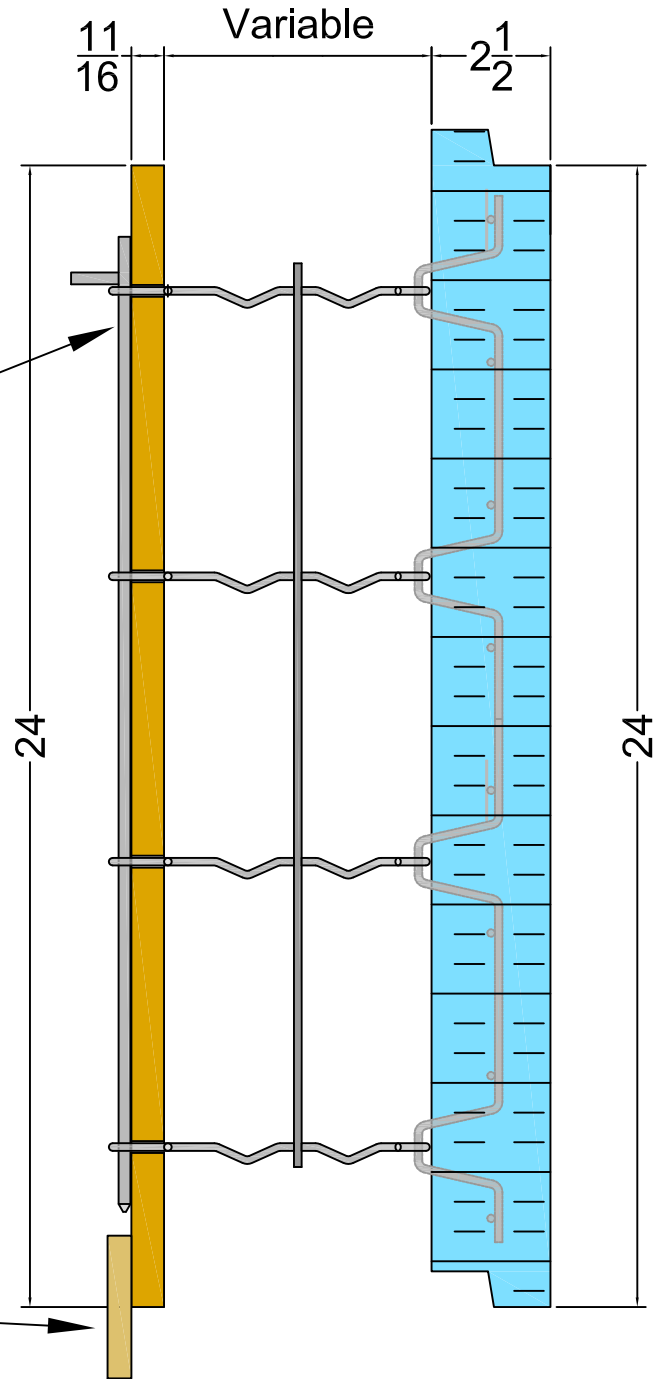

Big Block "V1"



DISCLAIMER NOTICE

SPECIFIC INFORMATION REQUIRED FOR COMPLIANCE WITH LOCAL CODES IS THE RESPONSABILITY OF THE DESIGNER.

TITLE:
Polycrete Big Block 1600 (24" x 96") + 11/16" PLYWOOD

DRAWING NO:
BB-24X96 SERIES V1 1/8

DATE
2016-12-12

DRAWING BY:
AG

REV. NO:
5

REV. DATE:
2017-01-03

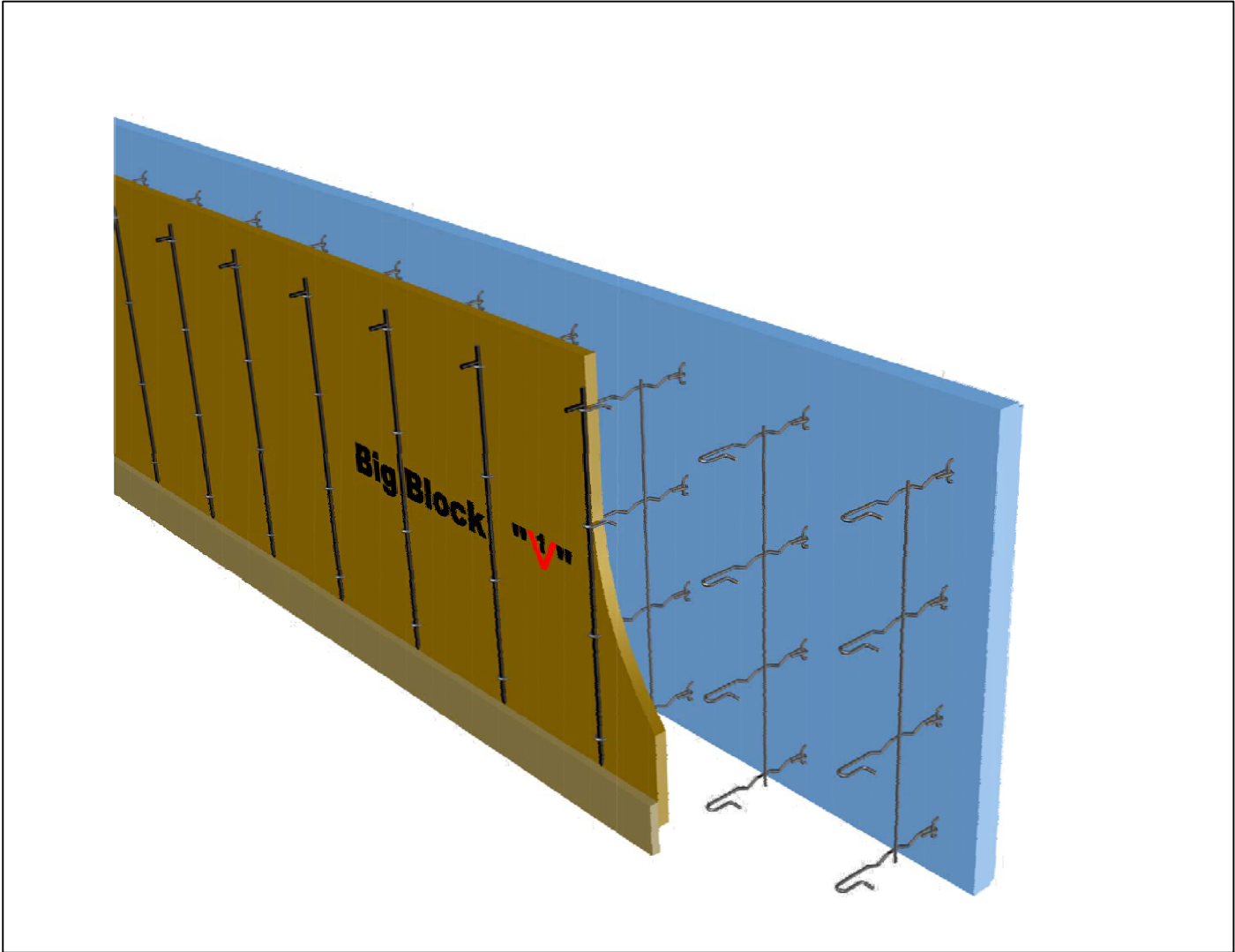

Big Block "V1"



DISCLAIMER NOTICE

SPECIFIC INFORMATION REQUIRED FOR COMPLIANCE WITH LOCAL CODES IS THE RESPONSABILITY OF THE DESIGNER.

TITLE:
Polycrete Big Block 1600 (24" x 96") + 11/16" PLYWOOD

DRAWING NO: BB-24X96 SERIES V1 7/8	DATE 2016-12-12
--	---------------------------

DRAWING BY: AG	REV. NO: 5	REV. DATE: 2017-01-03
--------------------------	----------------------	---------------------------------

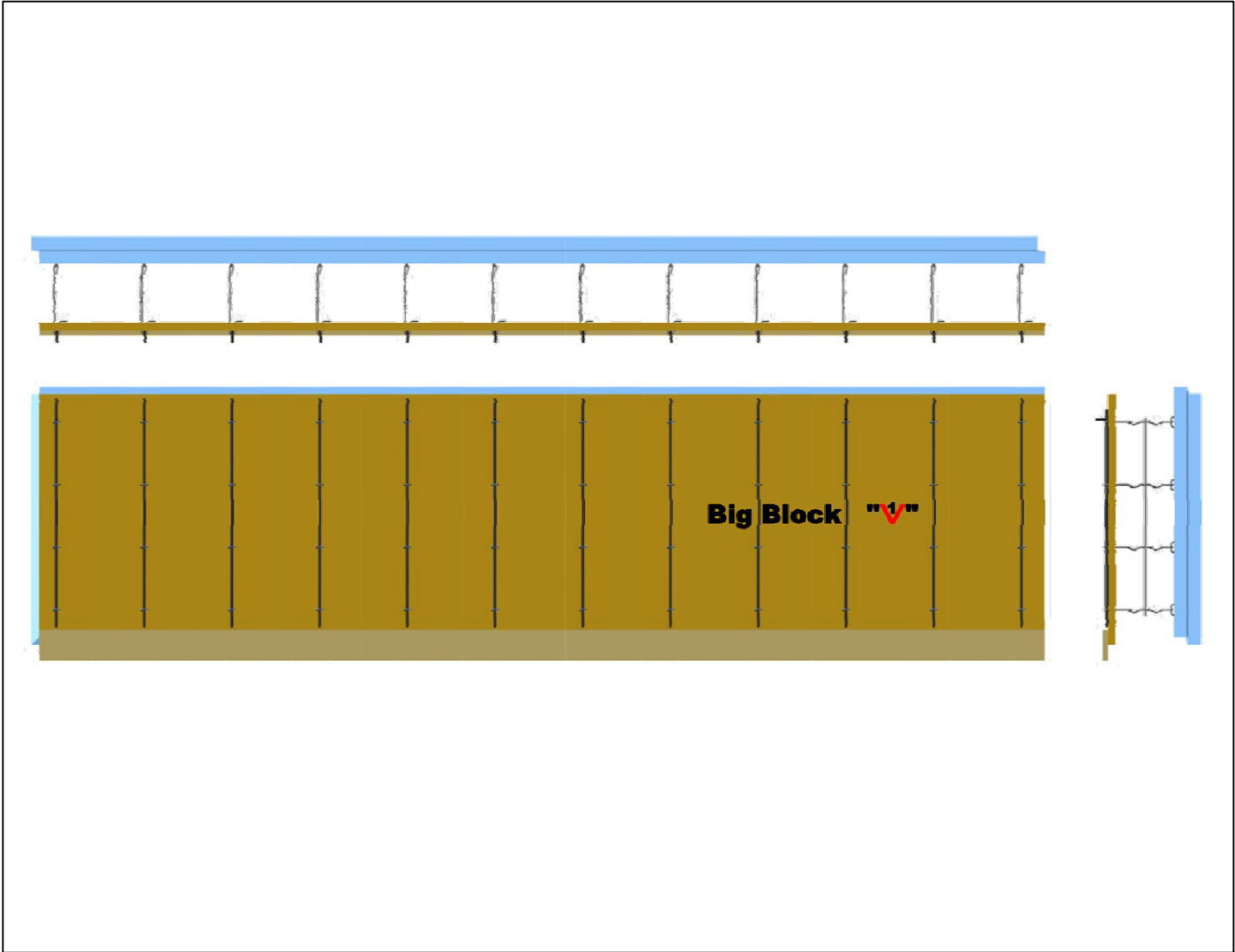

Big Block "V1"



DISCLAIMER NOTICE

SPECIFIC INFORMATION REQUIRED FOR COMPLIANCE WITH LOCAL CODES IS THE RESPONSABILITY OF THE DESIGNER.

TITLE:
 Polycrete Big Block 1600 (24" x 96") + 11/16" PLYWOOD

DRAWING NO: BB-24X96 SERIES V1 8/8	DATE 2016-12-12
--	---------------------------

DRAWING BY: AG	REV. NO: 5	REV. DATE: 2017-01-03
--------------------------	----------------------	---------------------------------

ULTRAFORM

1 - STEP CONCRETE FORM PANELS COFIFORM SP PLUS STRUC 1



The Ultimate Medium Density Forming Panel

Available only from Richmond Plywood Corporation, **ULTRAFORM** is the ultimate medium density overlaid forming plywood for concrete formwork. Also available in Class 1.

1. Easy to use and maintain, superior concrete finish, ULTRAFORM's overlay provides a smoother, matte-finish concrete that resists grain and patch transfer. Surfaces are treated with Nox-Crete release agent that protects the surface while reducing form damage and eases striking effort.
2. Re-usable, ULTRAFORM's strength and stiffness, impact resistance, tough overlaid surface, quality edge seal and EXTERIOR glue bond allow for multiple re-uses.
3. ULTRAFORM's low water transmission rate from a constant water/cement ratio results in a harder, denser concrete surface.

PRODUCT SPECIFICATION

As a member of the APA - Engineered Wood Association, all plywood manufactured by Richmond Plywood Corporation is subjected to APA's stringent quality control procedures. ULTRAFORM meets or exceeds CANPLY's COFIFORM SP PLUS standard.

ULTRAFORM is manufactured according to the specifications of CSA 0121 and its EXTERIOR grade glueline is WBP rated.

RELEASE AGENT

Each panel is treated with Nox-Crete™ form release agent. This inhibits moisture penetration into the panel as well as acts to improve the release of the panel from the concrete. Nox-Crete™ helps to eliminate concrete build-up and dusting and aids in ease of stripping.

CONSTRUCTION, DIMENSIONS AND PACKAGING

Every ULTRAFORM™ panel is Douglas fir with 7-ply construction for superior strength and stiffness.

Phenolic resin overlays on one or both sides maximize re-use potential.

Factory edges are painted blue with water and alkali resistant edge sealant.

Sizes: 4 x 8 foot (1220 x 2440 mm) standard dimension

Thicknesses & Packaging: 5/8" 50 panels/unit 5 ply (7ply upon request)
3/4" 40 panels/unit 7 ply

Other thicknesses and sizes or overlays on two sides are available on special order.



ULTRAFORM

THE ULTIMATE CONCRETE FORM PANEL.

CARE AND HANDLING

To achieve **ULTRAFORM's** full re-use potential, the following procedures are recommended:

STORAGE

Panels should be stored on a dry, level platform under shelter or otherwise protected. Steel straps should be cut and the forming surface of the top panel covered. Prolonged exposure to direct sunlight may cause degradation.

FORM CONSTRUCTION

Carbide-tipped blades are recommended. Cut or exposed edges must be resealed with a water and alkali resistant edge sealant or paint to prevent moisture absorption and minimize swelling.

Panels should be fixed to framing supports with screws. Screws can be countersunk and filled to maintain concrete appearance. Reduce joint leakage by filling joints with a suitable tape or expandable caulk.

Avoid chipping or denting panel surface and damage to panel edges during handling.

CONCRETE PLACEMENT

Use rubber-tipped vibrators for consolidation. Vibrators should not be used to move concrete horizontally in forms. As well, rate of pour and slump factor must be limited to that assumed in the design of the form.

CLEANING AND TREATMENT

Coat panels with Nox-Crete™ form release agent or equivalent quality chemically-active release agent before initial use and subsequent uses. This will simplify stripping and cleaning, lengthen form life and improve concrete appearance. Coatings such as diesel fuel, barrier release agents or crankcase oil are not recommended, as they may damage the MDO face. Use wooden wedges if aids for stripping are required. Using metal implements will cause perimeter damage. Clean panels immediately after stripping using non-abrasive tools such as brushes and plastic or wooden scrapers.

Minimum Width of Support (inch)	Centre to Centre Span (inch)	Allowable Pressure (psf) for the indicated deflection limits					
		L/180		L/270		L/360	
		5/8"	3/4"	5/8"	3/4"	5/8"	3/4"
1-1/2	4	4400	4630	4400	4630	4400	4630
	6	2450	2570	2450	2570	2450	2570
	8	1690	1780	1690	1780	1690	1780
	16	552	798	490	789	371	592
	24	240	365	160	269	120	202
	32	105	181	70	121	52	91



RICHMOND PLYWOOD CORPORATION

Richmond Plywood has been producing high quality plywood products since its inception in 1956 and is British Columbia's largest manufacturer of Douglas fir plywood.

ENVIRONMENTAL POLICY

The company is committed to sustainable forestry and reforestation and is in full compliance with all government forest practice regulations, including the Forest Practices Code of British Columbia.

LOAD SPAN DATA

The adjacent table gives allowable loads for various spans and plywood thicknesses. These loads were calculated using the procedures given in the CANPLY publication "Concrete Formwork" 1996.

The values given are applicable for ULTRAFORM spanning continuously across four or more supports, with face grain across supports parallel to span, (perpendicular to supports). All loading is to be uniformly distributed.

While every precaution has been taken to ensure that all the information contained in this publication is accurate, Richmond Plywood Corporation assumes no responsibility for any errors or oversights in the use of it or in the preparation of designs based on it or for any work based on it.

RICHMOND PLYWOOD GUARANTEE

ULTRAFORM is guaranteed against delamination of either inner ply or overlay surface, and against manufacturing defects for the life of the panel. If failure occurs, Richmond Plywood Corporation will reimburse the purchase price of the material or, at its option, replace the defective panel(s).



Richmond Plywood Corporation Ltd.
13911 Vulcan Way, Richmond, BC V6V 1K7
Tel: (604) 278-9111 Fax: (604) 278-2617

**"High Quality
Plywood Products
since 1956"**



Distributed by: